

# Retail Space for Lease



## Signature Station

Germanna Hwy & Somerset Ridge Road, Locust Grove, VA

 [Click Here for Street View](#)

**ANDREA PATRIZIO**  
Ph: 443.632.7464  
[Andrea@ParacleteRealty.com](mailto:Andrea@ParacleteRealty.com)

**CHARLIE PHELPS**  
Ph:301-536-7900  
[Charlie@ParacleteRealty.com](mailto:Charlie@ParacleteRealty.com)

2000 Duke Street, Suite 300 Alexandria, VA 22314  
301.536.7900 <http://www.paracleterealty.com>



# Property Overview

## Overview

New mixed use development



Adjacent to Walmart Supercenter & Germanna Community College (10,012 Students)



Traffic includes 28,000 VPD at the lighted intersection of Germanna Hwy & Somerset Ridge Rd

## Quick Facts

Multiple 1 acre pad sites

Freestanding & Inline Retail

230 residential units planned

Orange County Zoning C-2 (General Business)

## Demographics

	Pop.	Ave. Income	Households
3 Mi.	10,571	\$152,044	4,030
5 Mi.	17,162	\$150,357	6,532
10 Mi.	41,629	\$164,269	15,000
15 Mi.	165,218	\$144,777	58,276

# Concept Plan

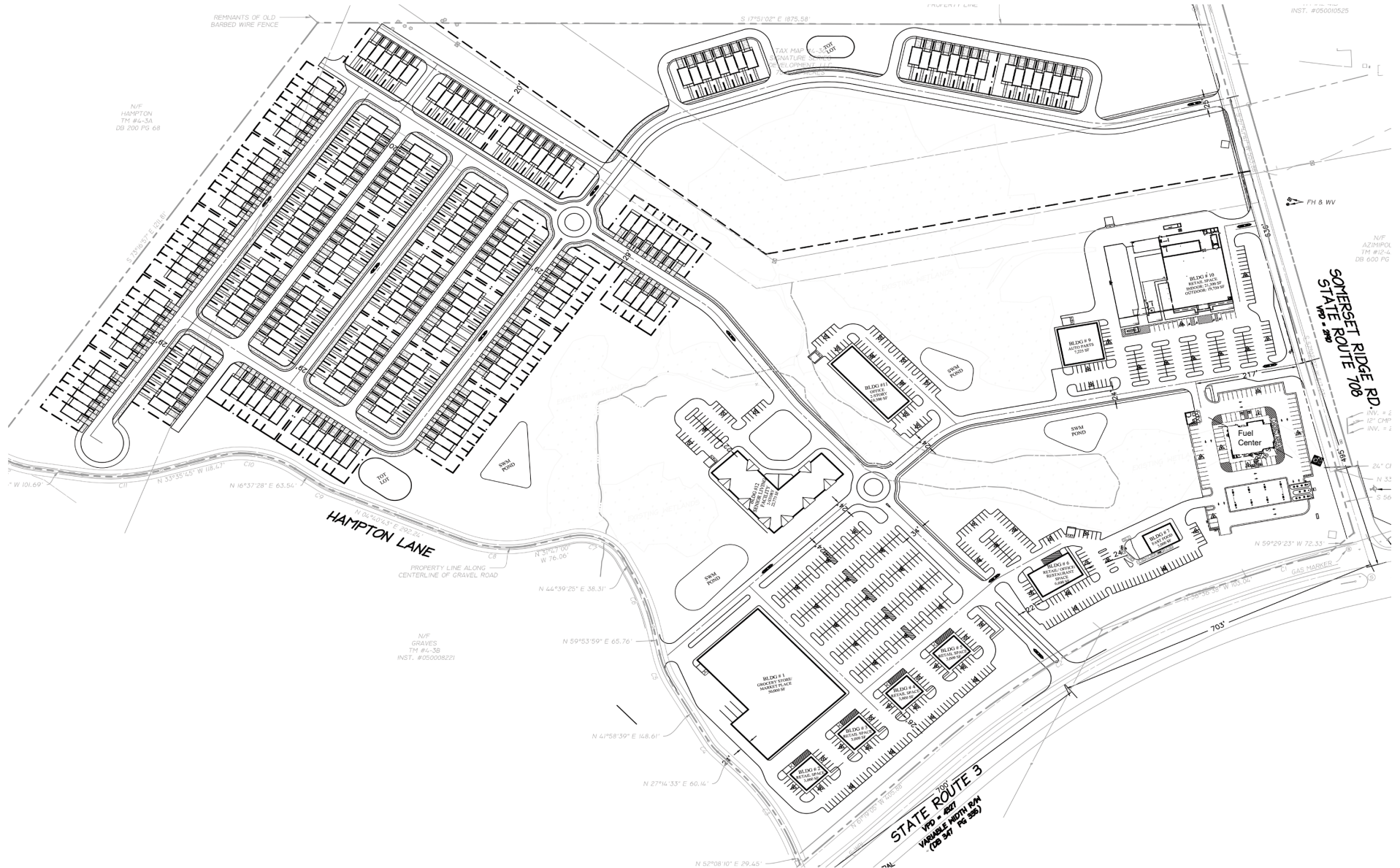

# Location Map

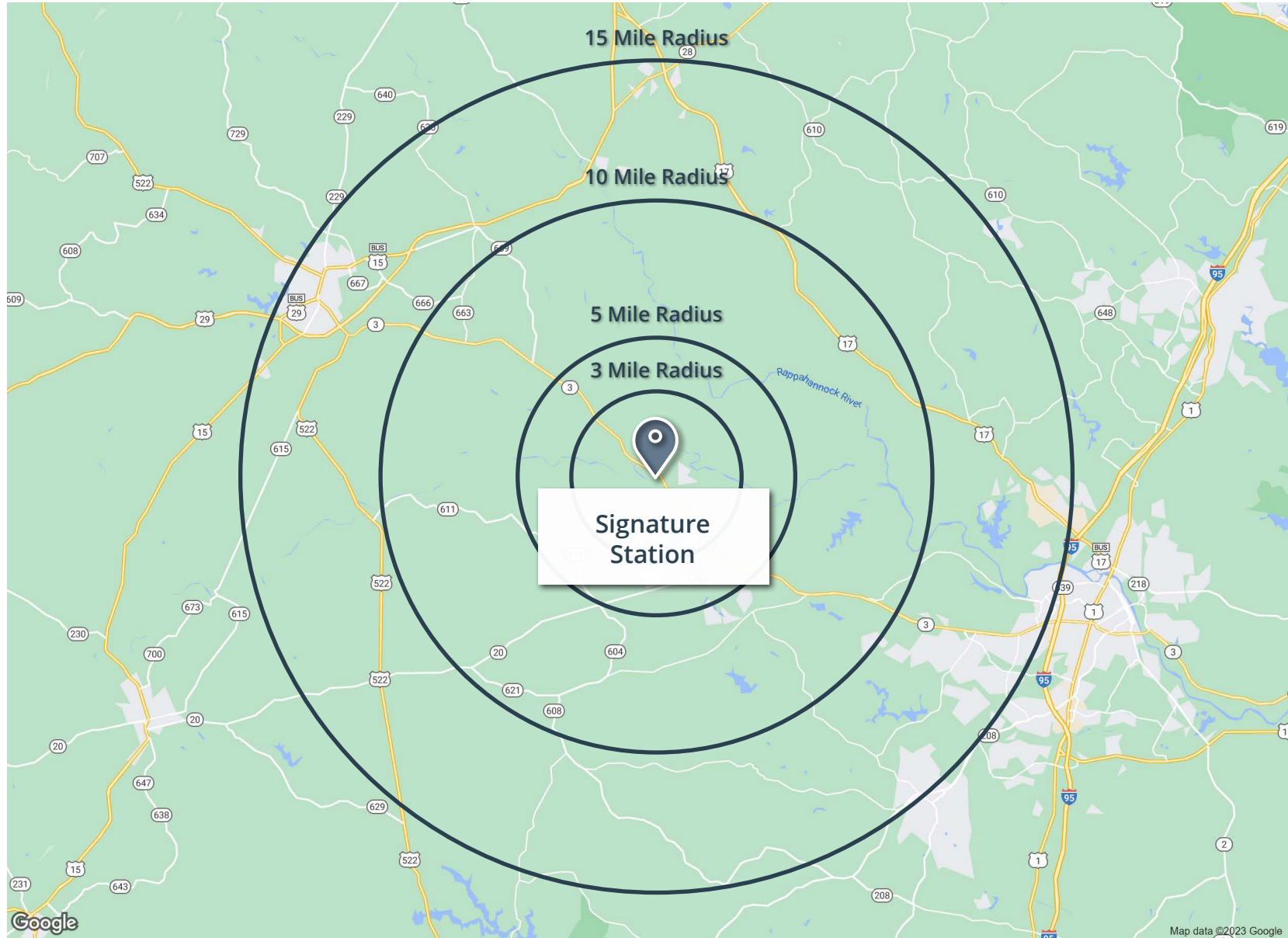

**SIGNATURE STATION**  
Germanna Hwy & Somerset Ridge Road, Locust Grove, VA

# Retail and New Housing Map



**SIGNATURE STATION**  
Germanna Hwy & Somerset Ridge Road, Locust Grove, VA